



Dish Cabinets

Stainless Steel Shelving



Use your smart phone to scan the above QR code to visit our website:
www.bk-resources.com

Certifications:



Features:

- 1 5/8" x 6" Adjustable S/S Leg
- 34 3/4" Overall Height
- Legs Adjust 1" in Height
- Fixed Intermediate Shelf

Material:

- Heavy Gauge Stainless Steel Top
- 18 ga. Stainless Steel Body

Length	T-304 S/S 15" Width	T-304 S/S 18" Width
36"	BKDC-1536	BKDC-1836
48"	BKDC-1548	BKDC-1848
60"	BKDC-1560	BKDC-1860
72"	BKDC-1572	BKDC-1872

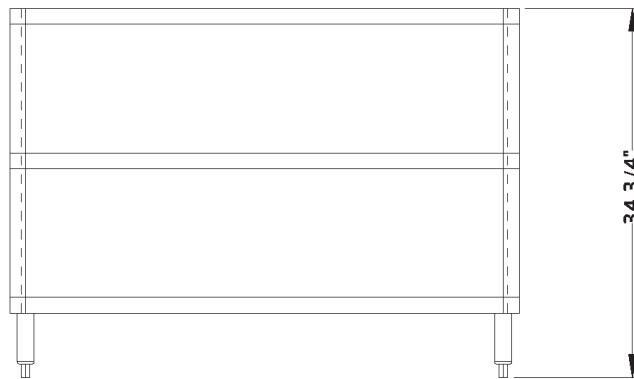
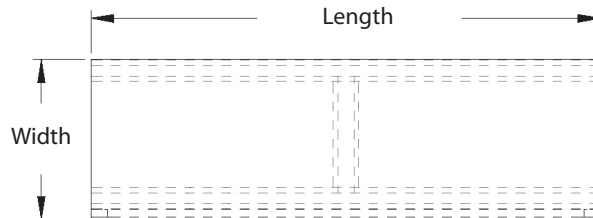

PRODUCT DATA SHEET

BK RESOURCES

