



RESOURCES

Chef Tables - Stainless Steel Top with 5" Riser

Stainless Steel Cabinet Base Tables with Hinged Doors

Certifications:



Features:

- 1 5/8" x 6" Straight S/S Leg
- 5" Riser
- Hinged Doors with or without Lock
- 96" Units have a Center Mullion with Two Sets of 48" Doors
- Legs Adjust 1" in Height
- Casters Available



Material:

- T-304 14 ga. Stainless Steel Top
- T-304 18 ga. Stainless Steel Body
- Stainless Steel Legs & Feet

Options:

- Adjustable Shelf



* Has a Center Mullion with Two Sets of 48" Doors on Each Side

Single Sided:

Length	Hinged Door		Hinged Door + Lock	
	24" Width	30" Width	24" Width	30" Width
18"	CSTR5-2418H	CSTR5-3018H	CSTR5-2418HL	CSTR5-3018HL
24"	CSTR5-2424H	-	CSTR5-2424HL	-
30"	-	CSTR5-3030H	-	CSTR5-3030HL
36"	CSTR5-2436H	CSTR5-3036H	CSTR5-2436HL	CSTR5-3036HL
48"	CSTR5-2448H	CSTR5-3048H	CSTR5-2448HL	CSTR5-3048HL
60"	CSTR5-2460H	CSTR5-3060H	CSTR5-2460HL	CSTR5-3060HL
72"	CSTR5-2472H	CSTR5-3072H	CSTR5-2472HL	CSTR5-3072HL
96"	-	CSTR5-3096H*	-	CSTR5-3096HL*

Dual-Access:

Length	Hinged Door		Hinged Door + Lock	
	24" Width	30" Width	24" Width	30" Width
18"	CSTR5-2418H2	CSTR5-3018H2	CSTR5-2418HL2	CSTR5-3018HL2
24"	CSTR5-2424H2	-	CSTR5-2424HL2	-
30"	-	CSTR5-3030H2	-	CSTR5-3030HL2
36"	CSTR5-2436H2	CSTR5-3036H2	CSTR5-2436HL2	CSTR5-3036HL2
48"	CSTR5-2448H2	CSTR5-3048H2	CSTR5-2448HL2	CSTR5-3048HL2
60"	CSTR5-2460H2	CSTR5-3060H2	CSTR5-2460HL2	CSTR5-3060HL2
72"	CSTR5-2472H2	CSTR5-3072H2	CSTR5-2472HL2	CSTR5-3072HL2
96"	-	CSTR5-3096H2*	-	CSTR5-3096HL2*

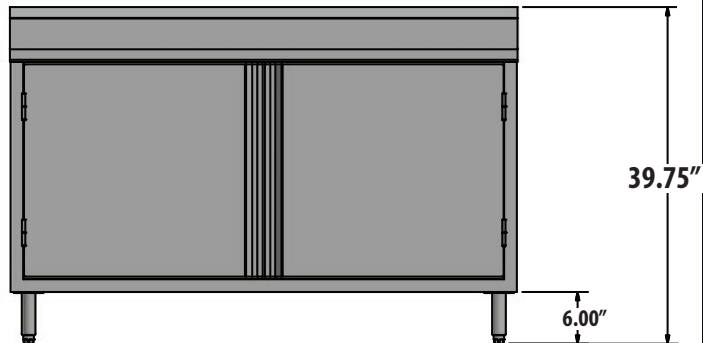
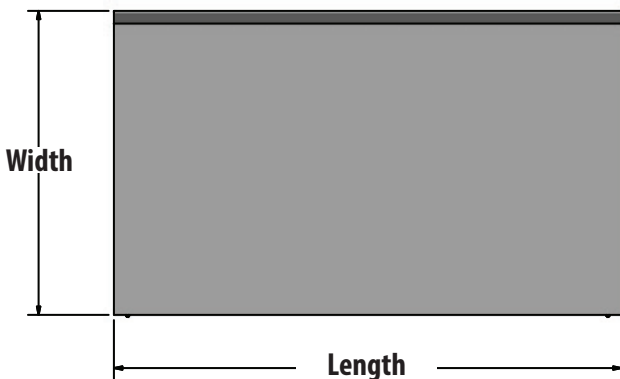

PRODUCT DATA SHEET

BK RESOURCES

